

TOTAL EXTENT (AS PERPATTA)

: 3418 SQ.M

ROAD AREA

: 190 SQ.M

PUBLIC PURPOSE AREA

: 32 SQ.M

(P.P-1 HANDED OVER TO THE LOCAL BODY - 16 SQ.M

(P.P-2 HANDED OVER TO THE TANGEDCO - 16 SQ.M

NO.OF.PLOTS

: 29 Nos.

NOTE:

1. SPLAY - 1.5M X 1.5M

2. MEASUREMENTS ARE INDICATED EXCLUDING SPLAY DIMENSION

3. ROAD AREA

PUBLIC PURPOSE AREA-1

PUBLIC PURPOSE AREA-2 (RESERVED FOR TANGEDCO)

WERE HANDED OVER TO THE LOCAL BODY VIDE GIFT DEED DOCUMENT NO. 4321/2020, DATED:21.12.2020 @ SRO POONAMALLEE.

CONDITIONS :

(I)THE APPLICANT SHOULD FOLLOW THE CONDITIONS MENTIONED BY THE CE, PWD/WRD, CHENNAI REGION, CHEPAUK, CHENNAI-5 IN LETTER NO. DB / T5 (3) / F - I & C - SORANCHERI - A VILLAGE - II / 2020 / M / 02.11.2020, ARE TO BE COMPLIED BY THE APPLICANT BEFORE ISSUING OF THE LAYOUT APPROVAL BY THE COMPETENT AUTHORITY (LOCAL BODY)

1.The process of earth filling and compaction should be done in layers of not more than 0.30 metre depth to achieve the required degree of compaction and the applicant land should be raised to a level of (+) 22.200.(i.e 0.60m above the existing road level of (+) 21.600m abutting the proposed site)

2.The all round pavement level during construction within the site should not be less than of (+) 22.200m. The applicant should provide all round and interior storm water drainage network, so that the ultimate disposal of storm water should be discharged to the nearest natural storm water channel/drains.

3.The applicant should take protective measures to avoid entry of Storm Water from the Road.

4.The sewage and sullage water should not be let out in the Channel and necessary sewage treatment plant arrangements should be constructed as per Pollution Control Board Norms at proposed site by promoter.

5.The applicant should construct the proposed RCC Box Culvert at their own cost. They are solely responsible for the structural safety and stability of the proposed culvert, at any cost the PWD/WRD will not be held responsible for design and drawing adopted for proposed construction of RCC Box Culvert.

6.The applicant should not carry out any other cross masonry structures across the government land without prior permission from PWD/WRD.

7.The proposed box culvert shall be made up of RCC Box Type with a minimum vent inner size of 9.0m width of 9.0m and height of 1.04m well within their boundary. The size & sill level of the proposed RCC culvert should be maintained as mentioned below in the specified S.F. No.240/2

8.The Construction of Abutment, wing wall, Return wall etc., should be constructed for each of the above proposed culverts should be constructed well within the applicants land on either side. Moreover the width of the government land as per revenue records should be maintained properly without any change at any cost.

9.The applicant should provide adequate rain water harvesting arrangements in the site at his own cost.

10.The applicant should make his own arrangements to collect the debris & garbages within the premises and has to be disposed off as per existing norms of Tamil Nadu Pollution Control Board and other department concerned and it should not be dumped in the nearby water bodies.

11.The applicant should not encroach into adjacent water body land and clearly demarcate the boundaries before starting developmental activities.

12.The applicant should abide by the rules and regulations of the PWD/WRD from time to time.

13.The permission granted to the applicant should not be altered/modified/changed to any others.

Failing to comply with any of the above conditions, PWD / WRD reserves the right withdraw the report on Construction of culvert across government land in the above Survey No., & as well as on Inundation point of view and in that event, the applicant shall not be eligible for any compensation what so ever.

(II)TNCDBR-2019, RULE NO: 47 (8) IN G.O(Ms) No.18,MAWS DEPARTMENT DATED:04.02.2019 & AMENDMENTS APPROVED

IN G.O.Ms.No.16, MAWS (MA1) DEPARTMENT DATED 31.1.2020 AND PUBLISHED IN TNGG ISSUE No.41, DATED 31.01.2020.

ONE PERCENT OF LAYOUT AREA EXCLUDING ROAD, ADDITIONALLY, SHALL BE RESERVED FOR "PUBLIC PURPOSE".

WITHIN THE ABOVE CEILING 0.5% OF AREA SHALL BE TRANSFERRED TO THE LOCAL BODY AND 0.5% OF AREA SHALL BE TRANSFERRED TO THE TANGEDCO OR TO THE LOCAL BODY FREE OF COST THROUGH A REGISTERED GIFT DEED BEFORE THE ACTUAL SANCTION OF THE LAYOUT.

(III) TNCDBR - 2019 ,RULE NO : 47 (11)

THE COST OF LAYING IMPROVEMENTS TO THE SYSTEMS INRESPECT OF ROAD, WATER SUPPLY, SEWERAGE, DRAINAGE OR ELECTRIC POWER SUPPLY THAT MAY BE REQUIRED AS ASSESSED BY THE CONCERNED AUTHORITY, NAMELY,THE LOCAL BODY AND TAMIL NADU ELCTRICITY BOARD, SHALL BE BORNE BY THE APPLICANT. COMPETENT AUTHORITY SHALL BE BORNE BY THE APPLICANT.

(IV)LOCAL BODY SHOULD ENSURE COMPLIANCE OF ALL THE CONDITIONS STIPULATED BY PWD IN THEIR LETTER NO.DB/T5(3) / F - I & C-SORANCHERI-A VILLAGE-II/2020/M/02.11.2020, OBTAIN A LETTER FROM PWD CONFIRMING THE COMPLIANCE OF THE CONDITIONS BEFORE THE SANCTION AND RELEASE OF THE LAYOUT.

NECESSARY SPACE FOR BUILDING LINE TO BE LEFT AS PER THE RULE IN FORCE WHILE TAKING UP DEVELOPMENT IN EVERY PLOT.

LEGEND :

- SITE BOUNDARY
ROADS GIFTED TO LOCAL BODY
EXISTING ROAD
PUBLIC PURPOSE-1 GIFTED TO LOCAL BODY
PUBLIC PURPOSE-2 GIFTED TO TANGEDCO.
CHANNEL
NO DEVELOPMENT AREA

CONDITION:-

THE LAYOUT APPROVAL IS VALID SUBJECT TO OBTAINING SANCTION FROM THE LOCAL BODY CONCERNED

P.P.D NO. 140
L.O 2020
APPROVED
VIDE LETTER NO : L1 / 7542 / 2020
DATE : 30 / 12 / 2020

FOR CHIEF PLANNER(LAYOUT)
CHENNAI METROPOLITAN
DEVELOPMENT AUTHORITY

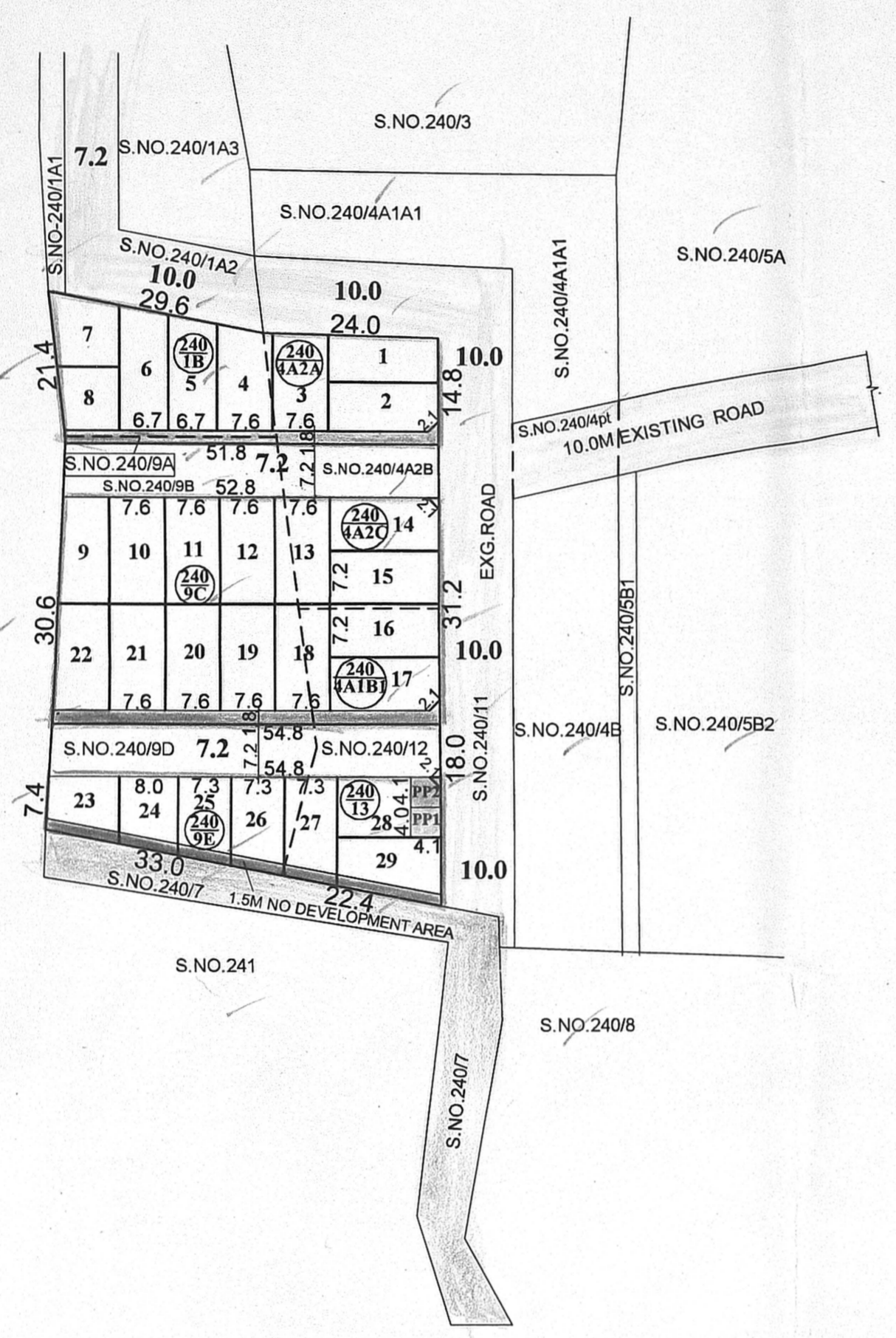

PREPARED BY

P.A.I

30/12/2020

POONAMALLEE PANCHAYAT UNION
LAYOUT OF HOUSE SITES IN S.Nos: 240/1B, 4A1B1, 4A2A, 4A2C, 9A, 9C, 9E & 240/13 OF SORANCHERI - 'A' VILLAGE.
SCALE-1:800 (ALL MEASUREMENTS ARE IN METRE)